



**Touch Screen v4
Change Package
or Option**

Tech Guide

WASHLINK SYSTEMS Add a Package or Option

This document provides comprehensive information for adding a wash package or option

When emailing or calling for assistance, you must have the following information available:

Location Name: _____

Contact Person: _____

Contact Phone: _____

Touch Screen version: _____

Touch Screen S/N: _____

Distributor Name: _____

COPYRIGHT

2011 Washlink Systems. All rights reserved.

THIS DOCUMENT IS THE EXCLUSIVE PROPERTY OF WASHLINK SYSTEMS AND IS PREPARED ONLY FOR USE BY THE COMPANY PURCHASING THE EQUIPMENT. EDITING, COPYING, DISTRIBUTING, AND/OR SELLING THIS DOCUMENT IS STRICTLY PROHIBITED WITHOUT PRIOR WRITTEN CONSENT FROM WASHLINK SYSTEMS. WASHLINK SYSTEMS RESERVES THE RIGHT TO EDIT THIS DOCUMENT IN ANY MANNER DEEMED NECESSARY, AT ANY TIME, AND WITHOUT PRIOR NOTICE.



1. From the Main Standard or Main Stacker Screen, press **OTHER**

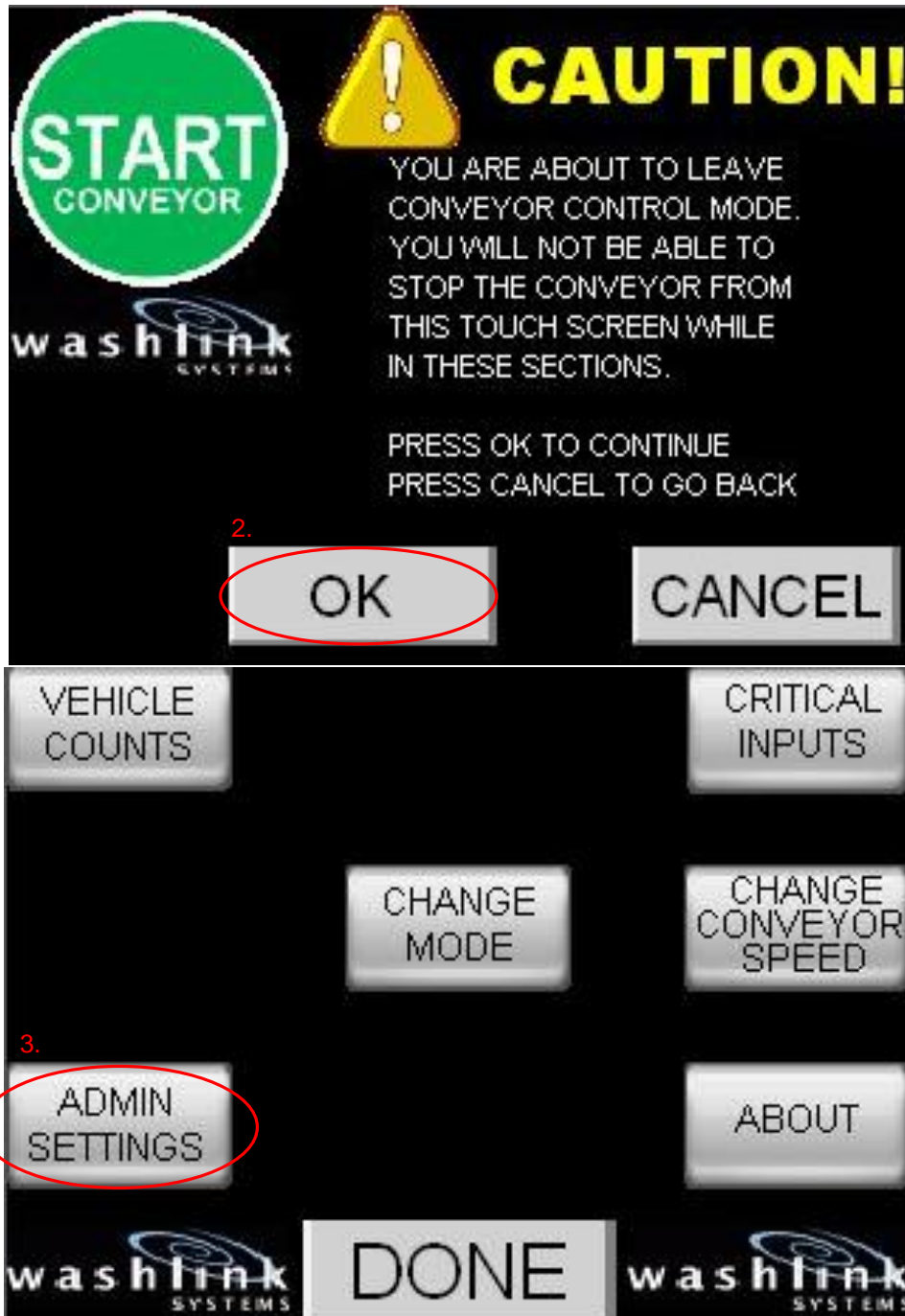

2. After reading warning message, press **OK**
3. Press **ADMIN SETTINGS**

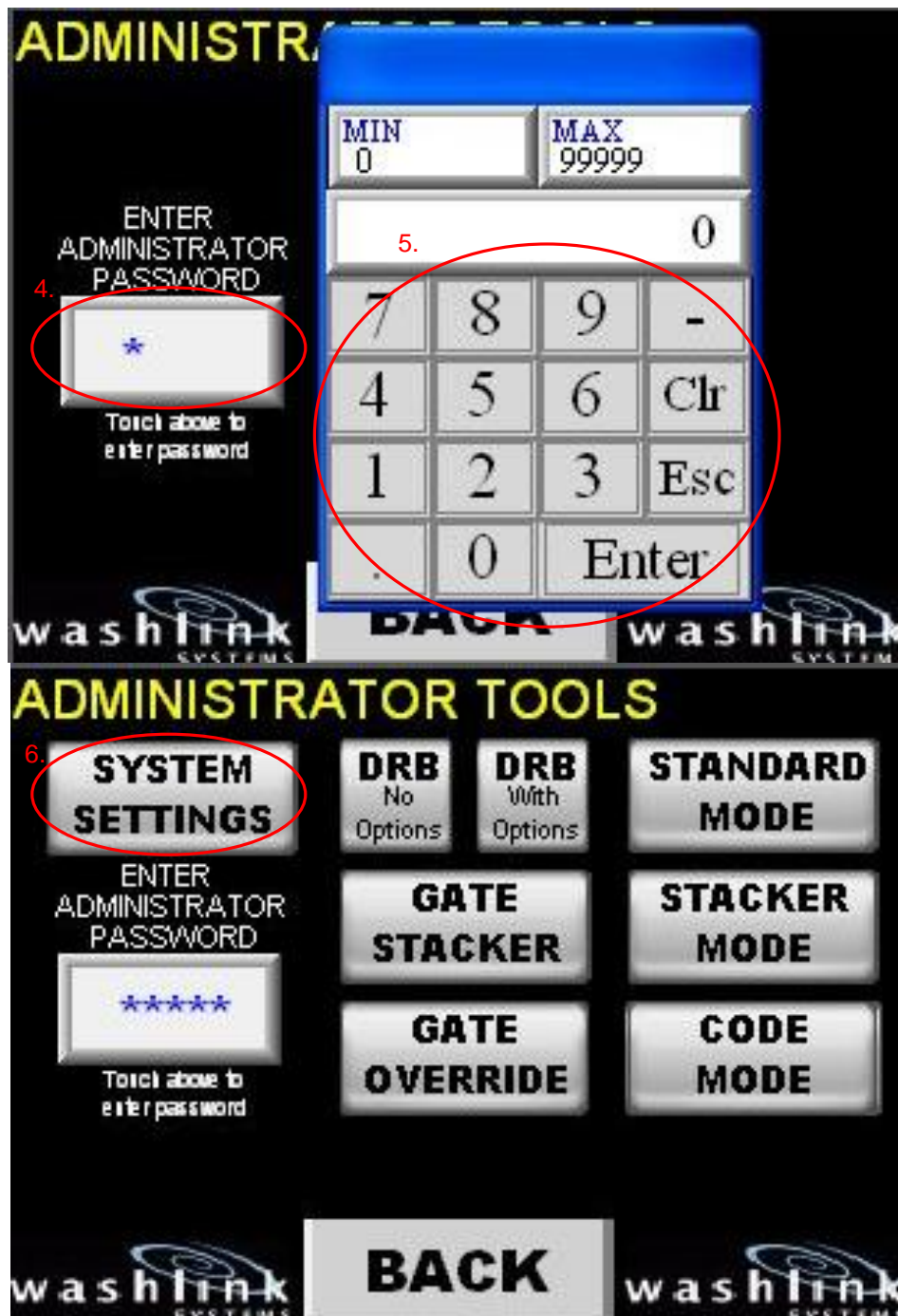

4. Press the **box** below ENTER ADMINISTRATOR PASSWORD
5. Number pad will pop up, Enter ADMINISTRATOR Password and press **Enter**
6. Press **SYSTEM SETTINGS**

V4.2.9 and below

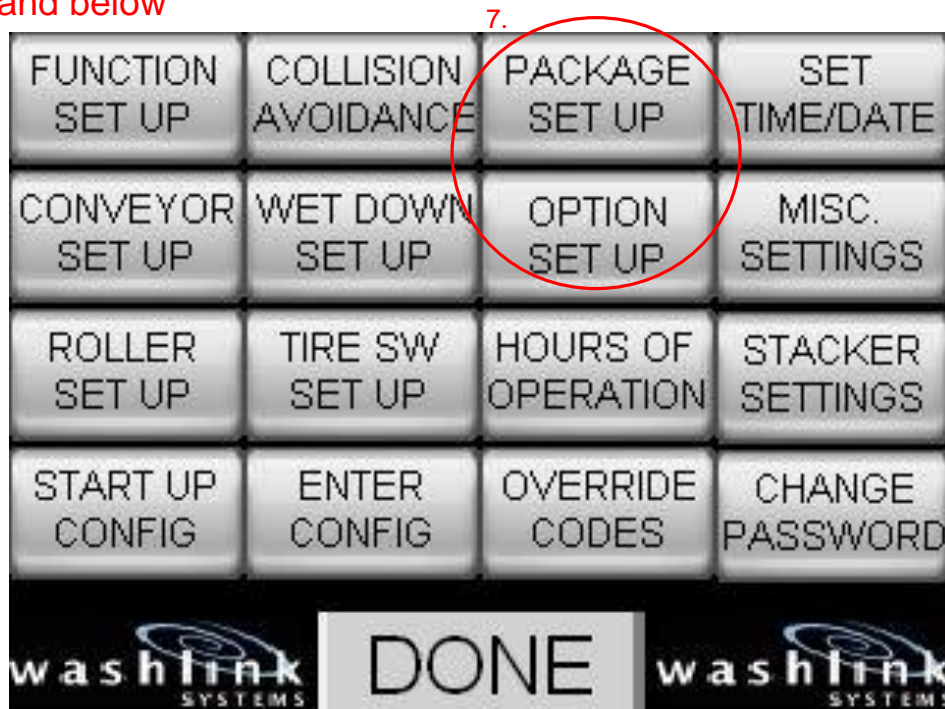

V4.4.1 and above

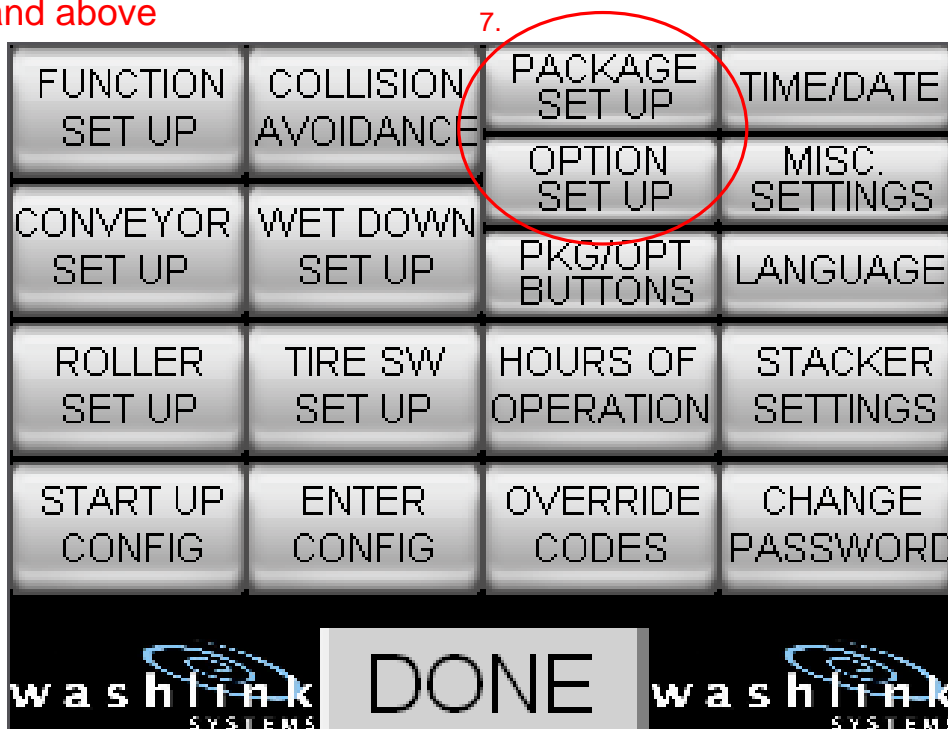

7. Press **PACKAGE SET UP** or **OPTION SET UP**

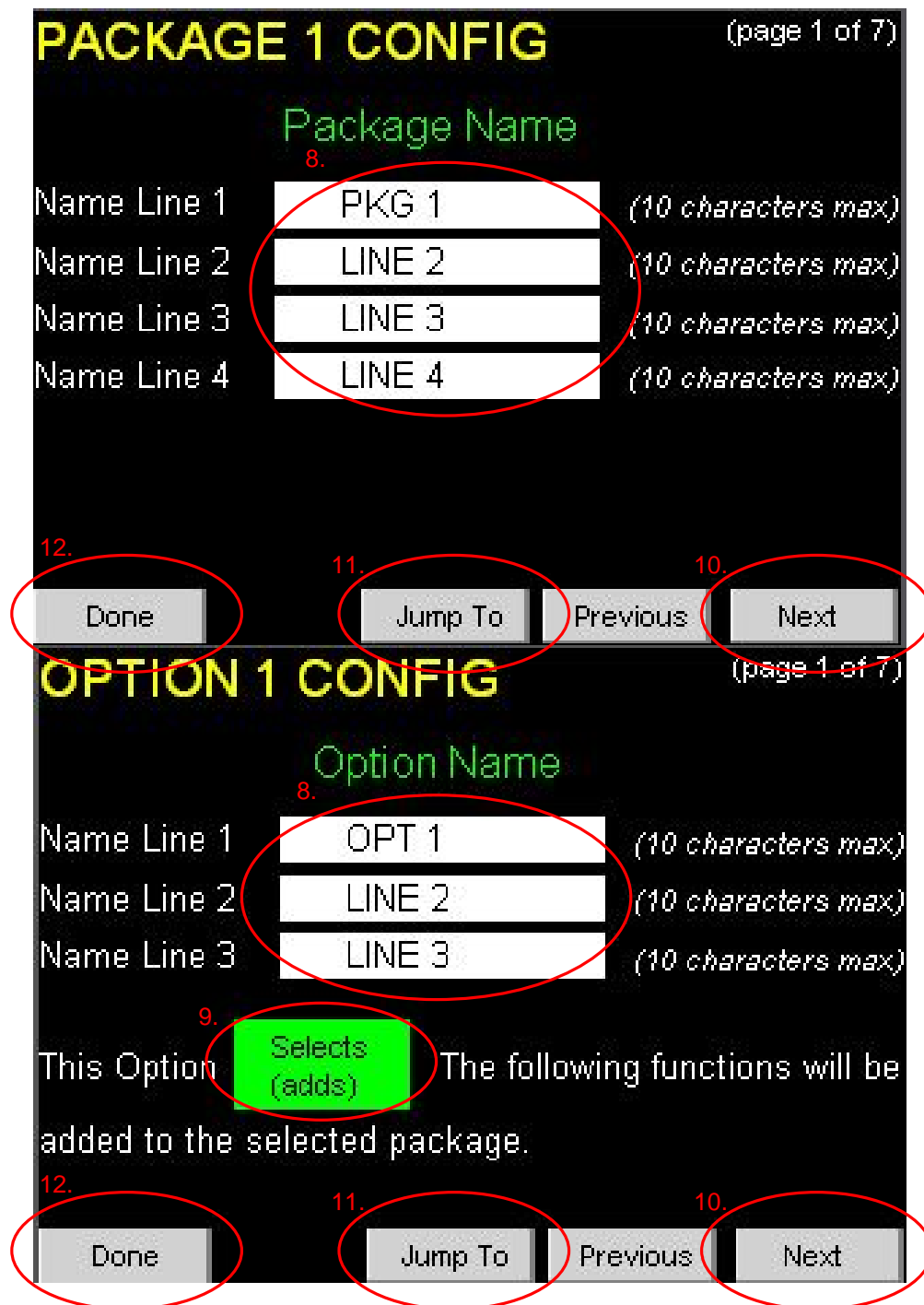

8. Press one of the **name lines** to change Package or Option Name
9. Press **De-Select** if Option is to De-Select (remove) functions from the vehicle being washed
10. Press **Next** to map functions to the Package or Option
11. To get to another Package or Option, press **Jump To**
12. Press **Done** to get back to Admin Settings

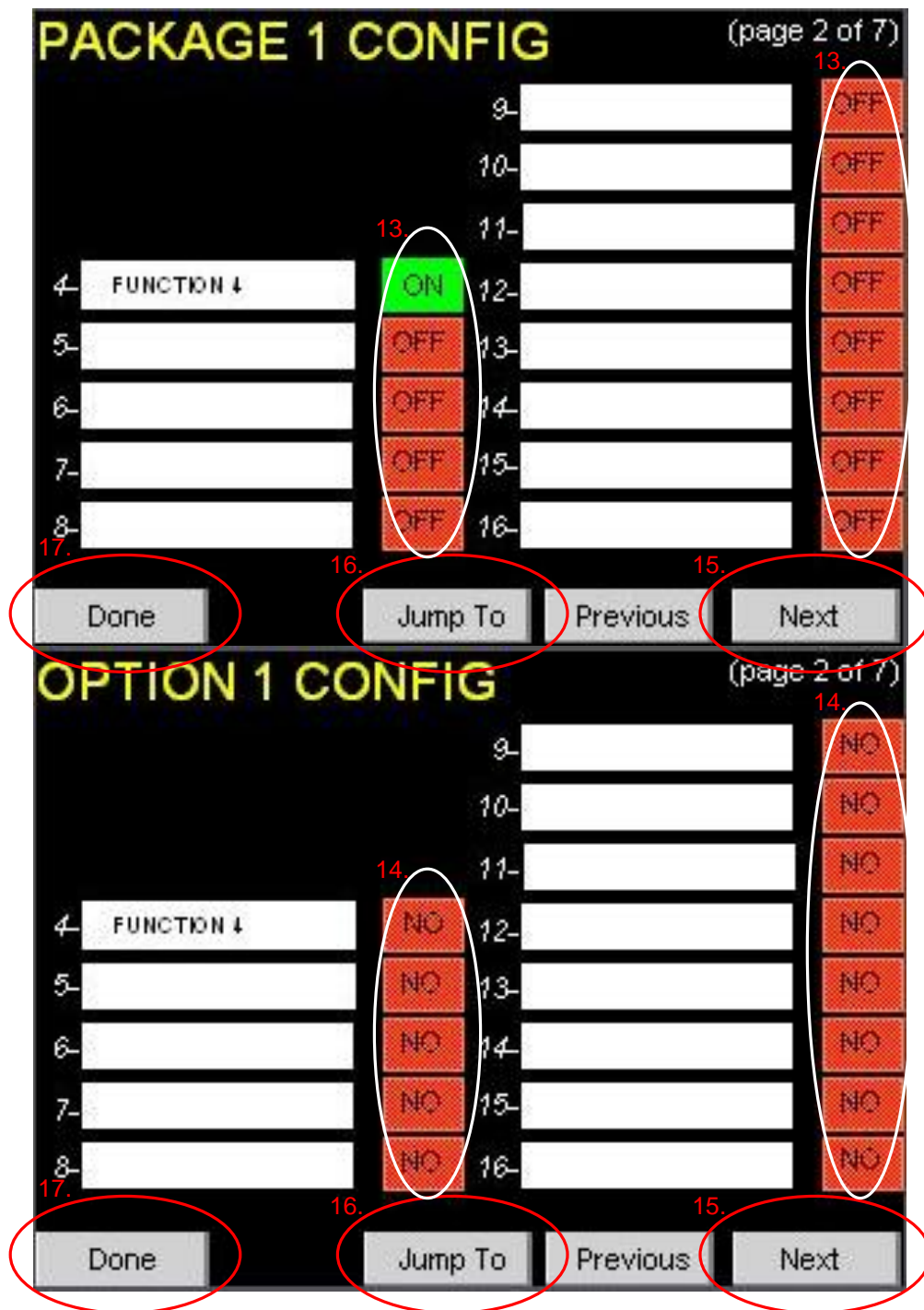

- 13. Press **ON/OFF** button to Map function to Package (ON=mapped to package)
- 14. Press **YES/NO** button to Map function to Option (YES=mapped to option)
- 15. Press **Next** to map additional functions to the Package or Option
- 16. To get to a specific Package or Option, press **Jump To**
- 17. Press **Done** to get back to Admin Settings

How to show Package & Option buttons on v4.2.9 and below

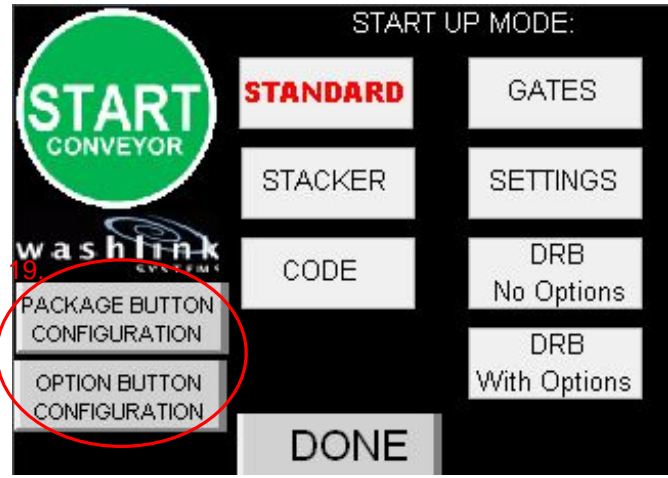

v4.4.1 and above

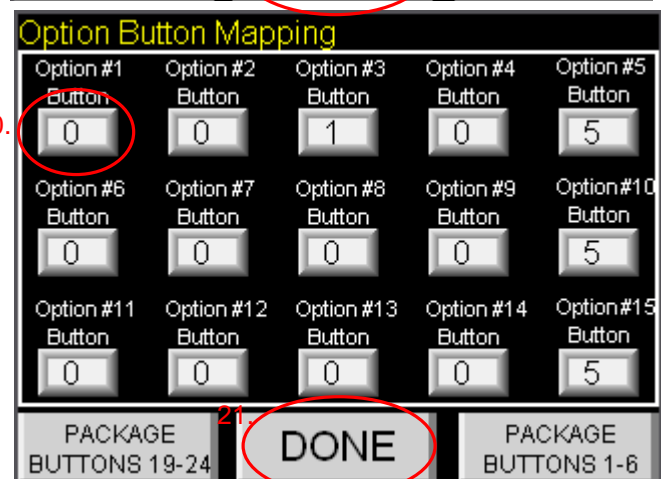
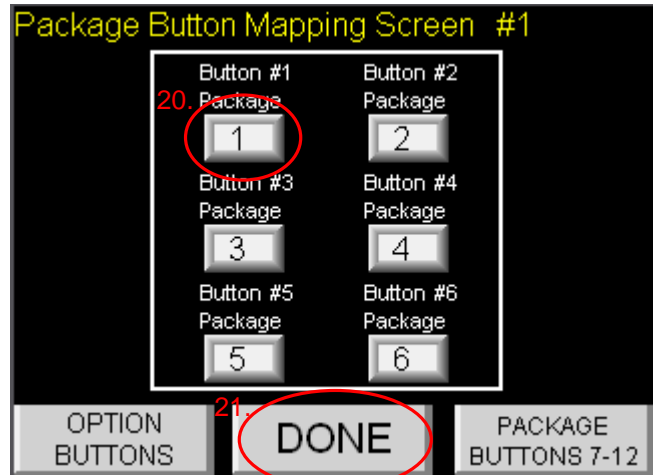
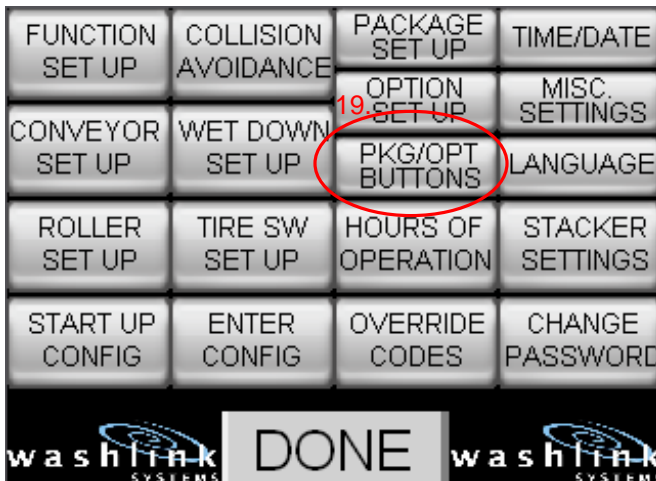

18. From the Admin Settings screen (v4.2.9 or below) press **START UP CONFIG**
19. Press **PACKAGE/OPTION BUTTON CONFIGURATION** (v4.2.9 and below) or
Press **PKG/OPT BUTTONS** (v4.4.1 and above)
20. Press the **Box** below the correct button location and enter in the Package or Option number to be used for that button. NOTE: 0=None, 1=Pkg/Opt 1, 2=Pkg/Opt 2 etc.
21. When finished, press **DONE** to get back to ADMIN SETTINGS